

Spaces to Live



The Lifestyler 48m²

Space to Live

At Portabuild we understand that New Zealanders crave the freedom and flexibility to live the way they want. So, we designed a range of cost-effective small home solutions to help more people just do that.

Our buildings meet Healthy Home standards and are engineered for a 50-year lifespan.

Our off-site build process means we can ensure quick manufacturing (often in just 5 working days!)*.

With two bedrooms the Lifestyler is a self contained accommodation building suitable for small families, first home buyers, downsizers or as a rental dwelling on your property.

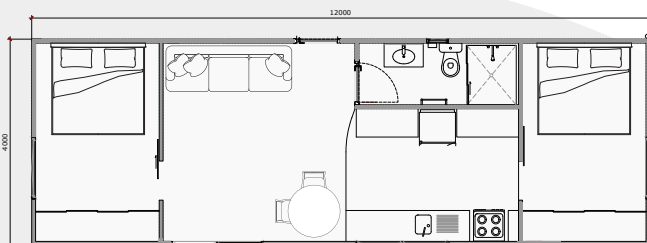

Specifications

Size: 12m x 4m

Cladding options:

- EPS Panel (Titania or Sandstone Grey)
- Corrugate (Vertical or Horizontal COLORSTEEL®)
- Corrugate + Timber (COLORSTEEL®)

Features:

- Ranchslider door
- Windows
- Trickle air vents to reduce condensation and increase airflow
- Bathroom with shower, toilet, vanity, and basin
- Kitchenette with cooktop, oven, rangehood, sink, and cupboard space
- Two separate double bedrooms
- Carpet tiles and vinyl plank flooring
- LED lighting
- Power points
- Heat pump
- Hot water supplied via gas califont

*Manufacturing times may vary, depending on (without limitation) the type of building, consent requirements, and availability of materials and subcontractors.

550 Halswell Junction Road, Christchurch
6 Garland Street, Matamata
0800 668 322 | portabuild.co.nz

